

FRAMED BED CANOPY HARDWARE INSTALLATION INSTRUCTIONS

GETTING STARTED

- Read through the instructions entirely before starting.
- Remove hardware from packaging.
- Do not dispose of packaging until the installation has been completed to your satisfaction.
- Make certain all parts indicated on the packaging list are included.
- Make certain all tools and supplementary hardware are on hand before starting.

TOOLS REQUIRED FOR INSTALLATION (NOT PROVIDED)

Installing on Wood Molding or Wood Studs:

-Screwdriver, level, tape measure, pencil, power drill

Installing on Wallboard:

-Screwdriver, level, tape measure, pencil, power drill, molley bolt screws or self-drilling anchors

Installing in Concrete, Stone, Brick or Tile:

-Screwdriver, level, tape measure, pencil, masonry drill, anchors, plugs or screws

ASSEMBLY INSTALLATION

1. Determine the appropriate location for the hardware
The height of the hardware should be calculated by:
 - A. Measuring the length of the canopy panels.
 - B. Deciding if you want the hem of the canopy panels hanging slightly above the floor, touching the floor or pooling on the floor.
2. Mark the appropriate location of each bracket with a pencil. Pre-drill the screw holes using a 1/4" (6.5 mm) drill bit.. Use Allen wrench to tighten the screw in each bracket. This holds the rod firmly in place within the bracket. **(see fig. 1)**
3. After securely installing the bracket, use an Allen wrench to tighten the screw in the inside, middle and outside rod. **(see fig. 2)**
- 4.

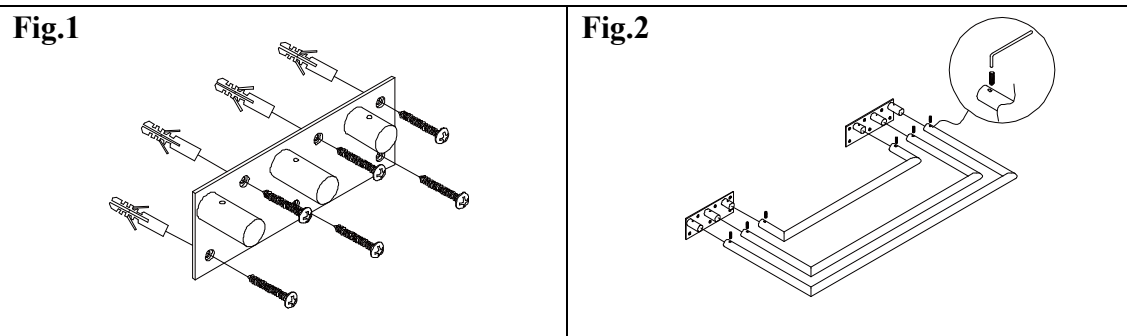

IMPORTANT: It is highly recommended that the brackets be attached to a structural wood support. If the studs within the wall are metal, you must pre-drill into the metal stud and use sheet-metal screws.