

MARCELINE TWIN/FULL BED WITH LOW FOOTBOARD

⚠ WARNING: ADULT ASSEMBLY ONLY OWING TO THE PRESENCE OF SMALL PARTS, SHARP POINTS AND EDGES.

PART LIST

- A HEADBOARD
- B SIDE RAILS
- C FOOTBOARD
- D SET OF BED SLATS

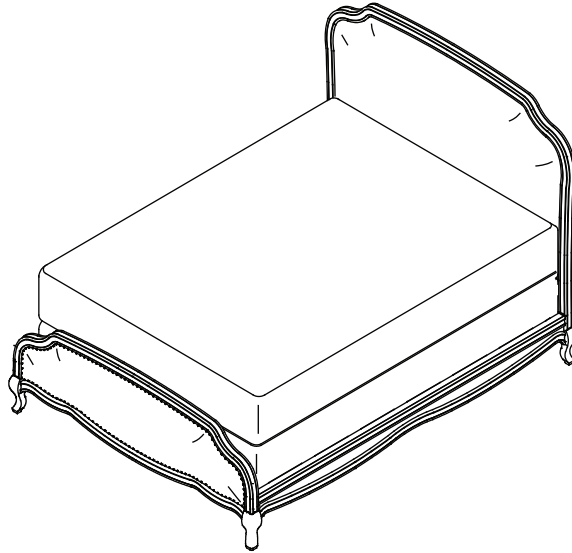

IMPORTANT

These bed parts can be cumbersome and heavy to some people, therefore the assistance of two or more people is recommended in order to prevent personal injury and ensure the bed parts are not damaged during the assembly process.

TOOLS AND HARDWARE LIST

NO		DESCRIPTION	QTY.
1		THREADED ROD	8 PCS.
2		CURVED WASHER	8 PCS.
3		LOCK WASHER	8 PCS.
4		HEX NUT	8 PCS.
5		WRENCH	1 PC

Customer Service - If you are missing parts or have any questions about this product please contact us at 1-800-762-1751

FIGURE 01

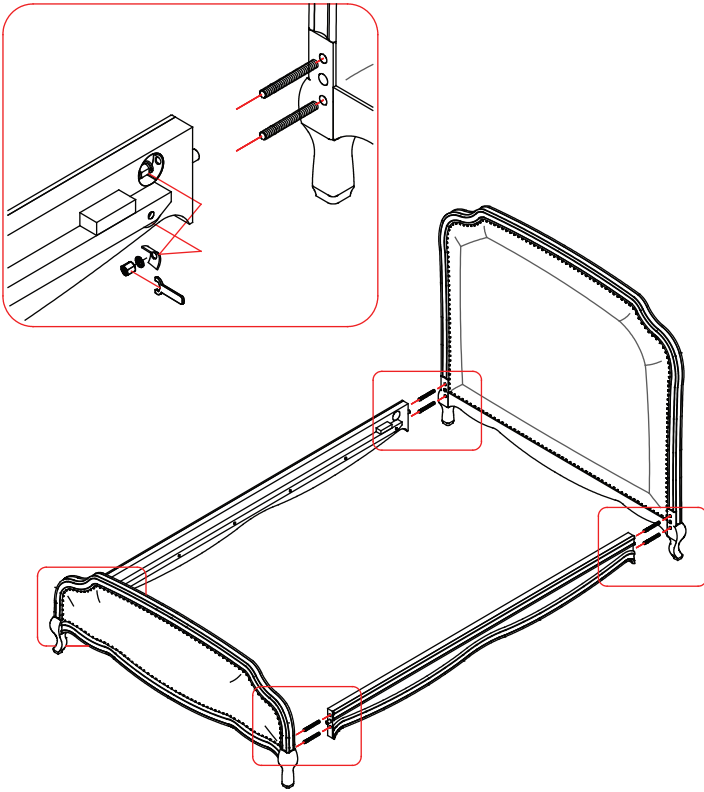

ASSEMBLY INSTRUCTIONS:

The bed is composed of several components: The Headboard, Footboard, Side Rails and set of Bed Slats. Determine the intended location and ensure there is enough space to work with and fully read these instructions before starting assembly.

STEP #1.

Place the Headboard (A) upright in the position you wish the bed to be in when fully assembled. The Headboard bed fast hardware should be facing inside, toward the mattress. Secure the Threaded Rod (1) to the fixed nut in the Headboard (A) by simply turning it manually. Raise the Side Rail (B) up and place the rod (1) to align with the bore holes on the end of the Side Rail (B). Put the Side Rail (B) up against the Headboard (A) so the Threaded Rods go through the bore holes. Insert Curved Washer (2) and Lock Washer (3), place Hex Nuts (4) on Threaded Rod (1), then tighten Hex Nuts (4) with Wrench (5), as illustrated in FIGURE 01.

FIGURE 02

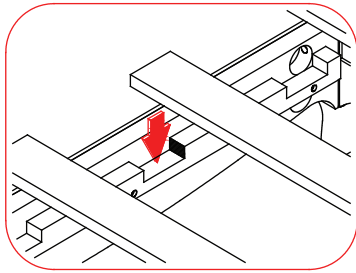

FIGURE 02 - A

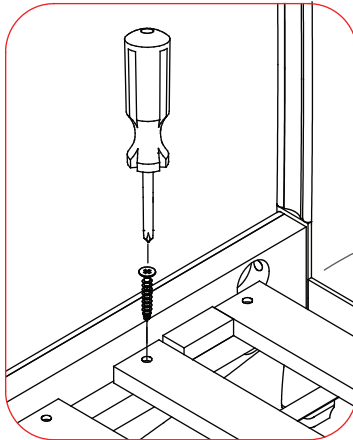

FIGURE 02 - B

STEP #4:

Repeat the above procedure with the other side rail (B) to attach it to the Headboard (A), and then repeat to connect Side Rail (B) to the Footboard (C).

STEP #5:

On inside surface of both Side Rails (B) are pre-installed wooden stopper cleats designed to hold the set of Bed Slats (D). Place Bed Slats (D) on both sides of the Side Rails (B), with the second to the last slat on either side of the stopper cleat, to hold the slats in place as in FIGURE 02-A. Once the slats (D) are set secure this with Screws (6) provided as in FIGURE 02-B.

