

RH BABY & CHILD

DRAKE TWIN BED INSTRUCTIONS

PARTS INCLUDED:

A [1] HEADBOARD PANEL
B [1] FOOTBOARD PANEL
C [2] SIDE RAILS
D [3] STRETCHER BARS
E [2] PLATFORM PANELS

TOOLS NEEDED:



Phillips-head Screwdriver (not included)

| NO. | ITEM | DESCRIPTION | QTY. |
|-----|------|-------------------------|---------|
| 1 | | Threaded Rod 5/16" x 3" | 8 pcs. |
| 2 | | Curved Slotted Washer | 8 pcs. |
| 3 | | Hex Nut 5/16" x 12mm | 8 pcs. |
| 4 | | Allen Wrench 12mm | 1 pc. |
| 5 | | Screw 8 x 30mm | 26 pcs. |

ASSEMBLY INSTRUCTIONS:

STEP 1:

Place the Headboard (A) upright in the position you wish the bed to be in when fully assembled. The Headboard bed fast hardware should be facing the inside, toward the mattress.

Secure the Threaded Rod (1) to the Headboard (A). Raise the Side Rails (C) up and place the rod into the Side Rails (C) at the bore holes' position, insert Curved Slotted Washer (2) and tighten Hex Nuts (3) using Wrench (4).

Repeat the procedure with the side rail end and Footboard (B).

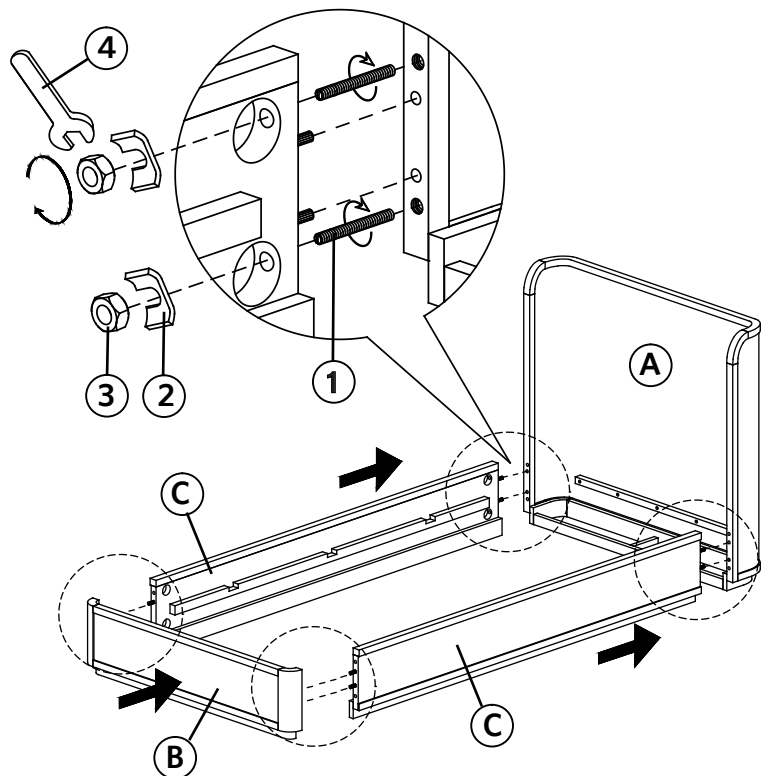

STEP 2:

Lay the Stretcher Bars (D) in between the Side Rails (C), and attach using Qty.6 Screws (5) with Phillip-head Screwdriver.

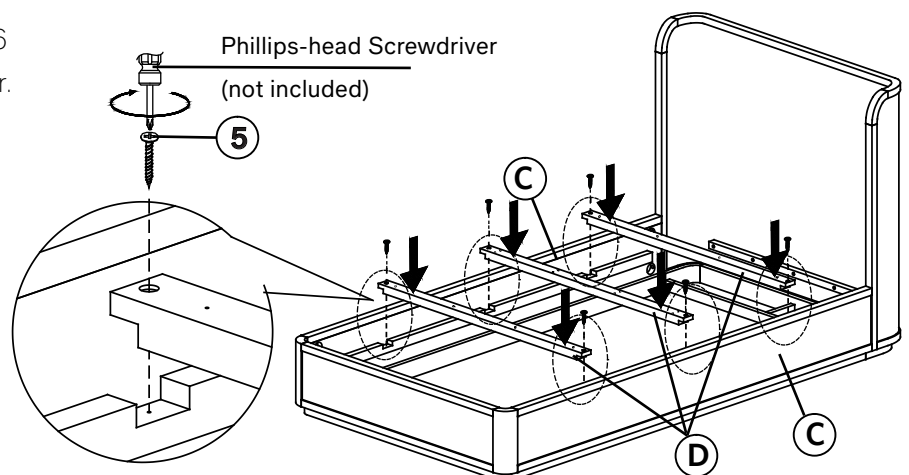

STEP 3:

Lay the Platform Panels (E) on top of the Stretcher Bars (D) and attach using Qty.20 Screws (5) with Phillip Head Screwdriver.

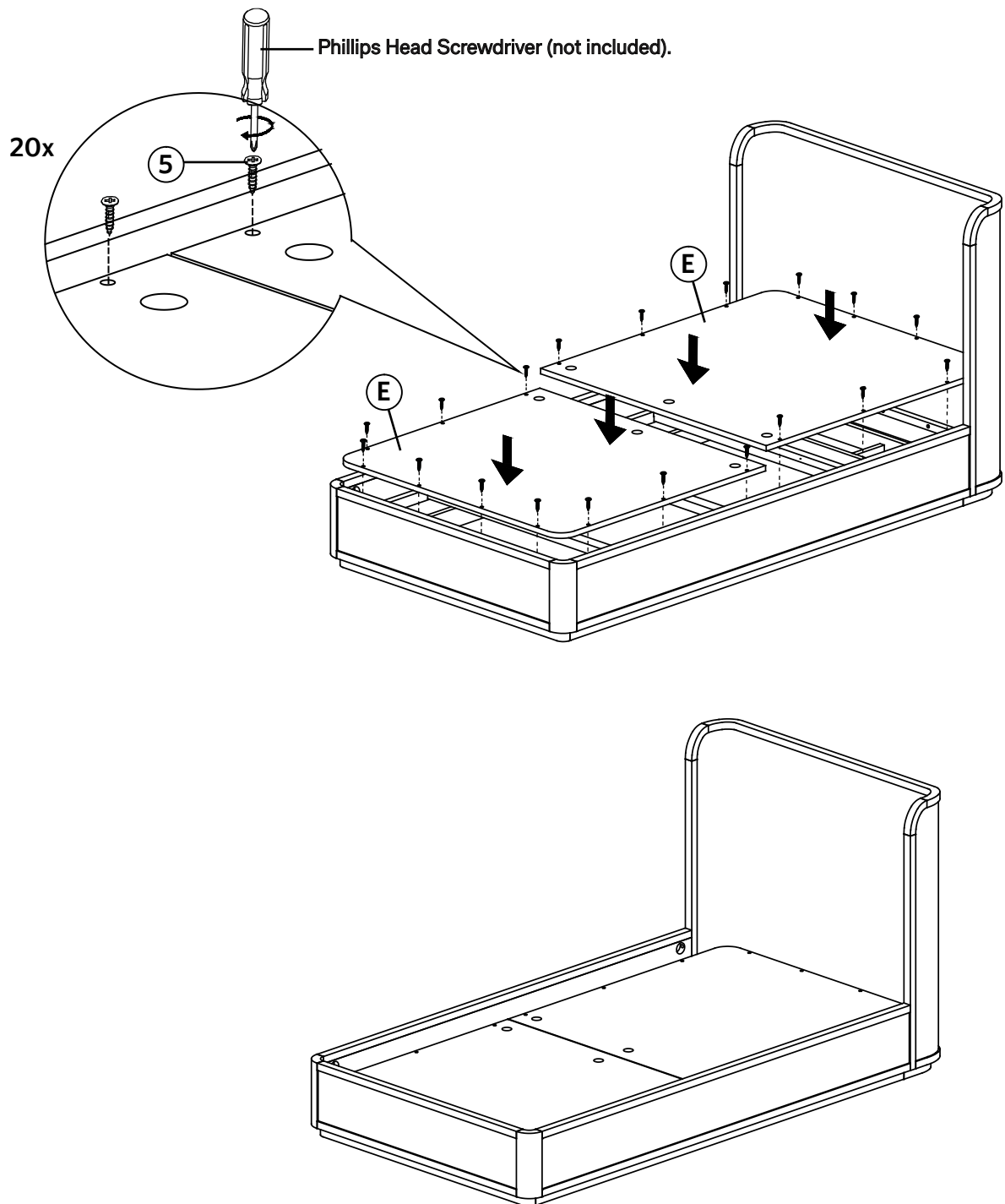

CARE INSTRUCTIONS:

1. Dust often using a clean, soft, dry lint-free cloth.
2. Blot spills immediately, and wipe with a clean, damp cloth.
3. We do not recommend the use of chemical cleansers, abrasives or furniture polish on our lacquered finish.