

# baby&child

## RESTORATION HARDWARE

### CAMDEN TIERED PENDANT

#### PARTS ENCLOSED:

(A) Canopy (1)	(a) Wire Connector (3)
(B) Extension Rod (1)	(b) Mounting Plate (1)
(C) Extension Rod (1)	(c) Ground Wire Screw (1)
(D) Extension Rod (1)	(d) Plate Screw (2)
(E) Extension Rod (1)	(e) Canopy Screw (4)
(F) Top Shade (1)	(f) Small Screw (2)
(G) Middle Shade (1)	(g) "C" ring plate (1)
(H) Bulb (1)	(h) Set Screw (1)
(J) Cluster Socket (1)	(i) Allen Wrench (1)
(K) Bottom Shade (1)	(j) Washer (1)
(L) Top Drop Post (1)	(k) Metal plate (1)
(M) Bottom Drop Post (1)	(m) Washer (1)
(N) Diffuser (1)	
(P) Finial (1)	

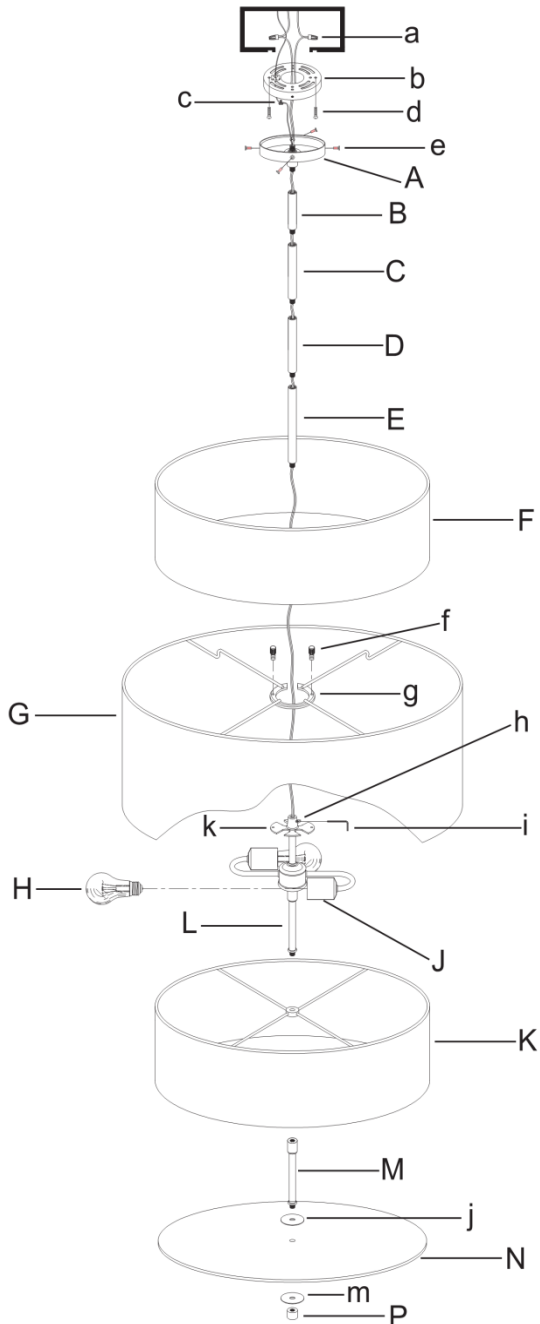

#### IMPORTANT SAFETY INSTRUCTIONS:

WE STRONGLY RECOMMEND INSTALLATION BY A LICENSED ELECTRICIAN. This fixture has been rated for up to one (2) 100W-type A bulb. To avoid the risk of fire, do not exceed the recommended wattage.

#### WARNINGS:

All wires are connected. When unpacking, be careful not to pull wires as a bad connection may result. Do not connect electricity unless your fixture is fully assembled. To reduce the risk of fire, electrical shock, or personal injury, always turn off fixture and allow it cool prior to replacing the light bulb. Do not touch the bulb when fixture is turned on or look directly at lit bulb. Keep flammable materials away from lit bulb.

THIS IS NOT A TOY AND THE PRODUCT HAS NO PLAY VALUE.

#### ASSEMBLY & INSTALLATION:

- Carefully remove all parts from the box and remove the plastic covering.
- TURN OFF THE MAIN ELECTRICAL SUPPLY FROM THE MAIN FUSE BOX.
- Screw Extension Rod (B) to Canopy (A).
- Screw Extension Rod (C) to Extension Rod (B).
- Repeat Step 4. to complete the assembly for Extension Rod (D) & (E).
- Screw the Metal Plate (k) to Extension Rod (E). Screw the Set Screw (h) to secure it using the Allen Wrench (i).
- Place the Middle Shade (G) onto the Metal Plate (k), secure the "C" Ring Plate (g) and Metal Plate (k) using the Small Screw (f).
- Place the Top Shade (F) onto the Middle Shade (G).
- Attach the Mounting Plate (b) to the outlet box using the Plate Screw (d).
- Attach the ground wire (usually green or bare wire) from the fixture to the ground junction box wire from the outlet box (usually green or bare wire) with a Wire Connector (a) and wrap the connection with electrical tape or screw the Ground Wire Screw (c) into the Mounting Plate (b) and wrap the fixture's bare ground wire around the Green Ground Wire Screw (c).
- Connect the hot wire to the junction box wire (usually black) with a Wire Connector (a) and wrap the connection with electrical tape. Connect the neutral wire to the junction box wire (usually white) with a Wire Connector (a) and wrap the connection with electrical tape.
- Attach the Canopy (A) to the Mounting Plate (b) using the Canopy Screw (e).
- Screw the Bulb (H) (not included) into the threading Socket (J).
- Secure the Bottom Shade (K) onto the Top Drop Post (L) using Bottom Drop Post (M).
- Place the Diffuser (N) onto the Bottom Drop Post (M), attach the Finial (P) and tighten to secure the diffuser.  
※ In order to prevent the diffuser get scratched, place Washer (j) and (m) at each side of the Diffuser (N), as shown. ※

#### CARE INSTRUCTIONS:

Do not use polishes or cleaners on your fixture. Just wipe clean with a soft cloth.